

Mobile Belt Conveyor can be used at desired locations for product conveying, loading, unloading, stocking and reclaiming; in variable heights and degrees, in many different occasions.

Usually, it is preferred for ship loading, grain storage sites, mine and quarries, screening and washing plants.



## PRODUCT FEATURES

Mobile Belt Conveyor has a portable feature to be used at desired points for its integrated wheel drive mechanism.

Because of the hydraulic system that is used in the conveyor, unloading process can be applied at determined angular spacing. It provides unloading opportunity at wide measuring range owing to its adjustable degree and height. Radial movement can be provided by changing wheel degree. This feature enables unloading operation on different points while the product inlet point is fixed. The pipe at the discharge chamber is able to turn 360 degrees and move up and down, so that it provides alternative during the unloading.

### STANDARD EQUIPMENTS:

- Coupled Motor Reducer
- Anti Static Rubber Belt
- Inlet and Discharge Chamber
- Dust-Sealing Felt
- Belt Tension Mechanism
- Tail
- Drive Head Drum Rubber Coating

### OPTIONAL EQUIPMENTS:

- Impact Rollers for Conveyor
- Helical Belt Cleaning Rollers
- Discharge Chamber - Polyethylen Coating
- RPM Sensor
- Top Closure
- 360 Degree Discharge Chamberi

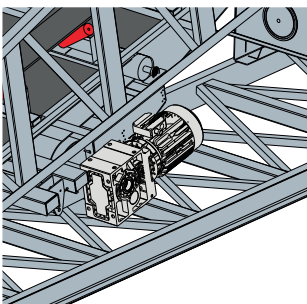

Driving Head

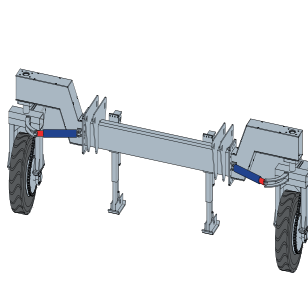

Axle Chassis

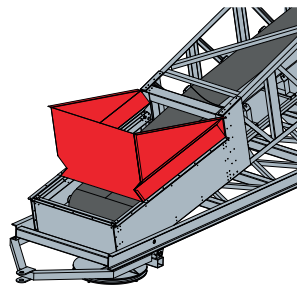

Product Inlet

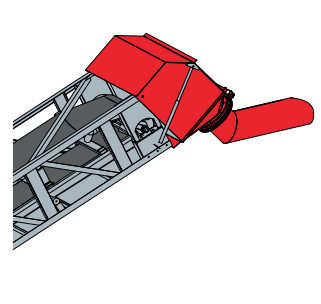

Discharge Section

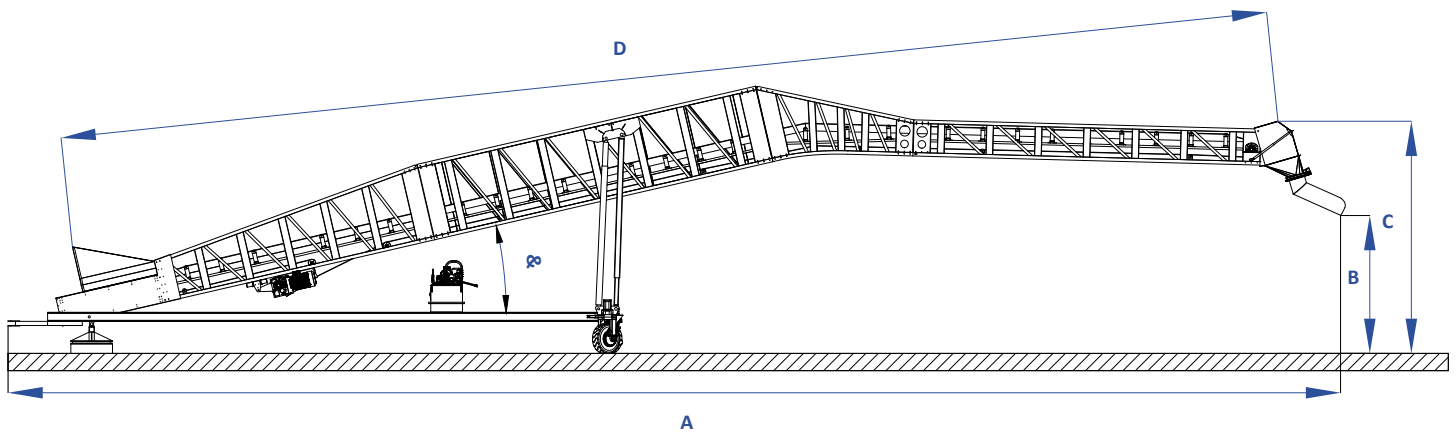
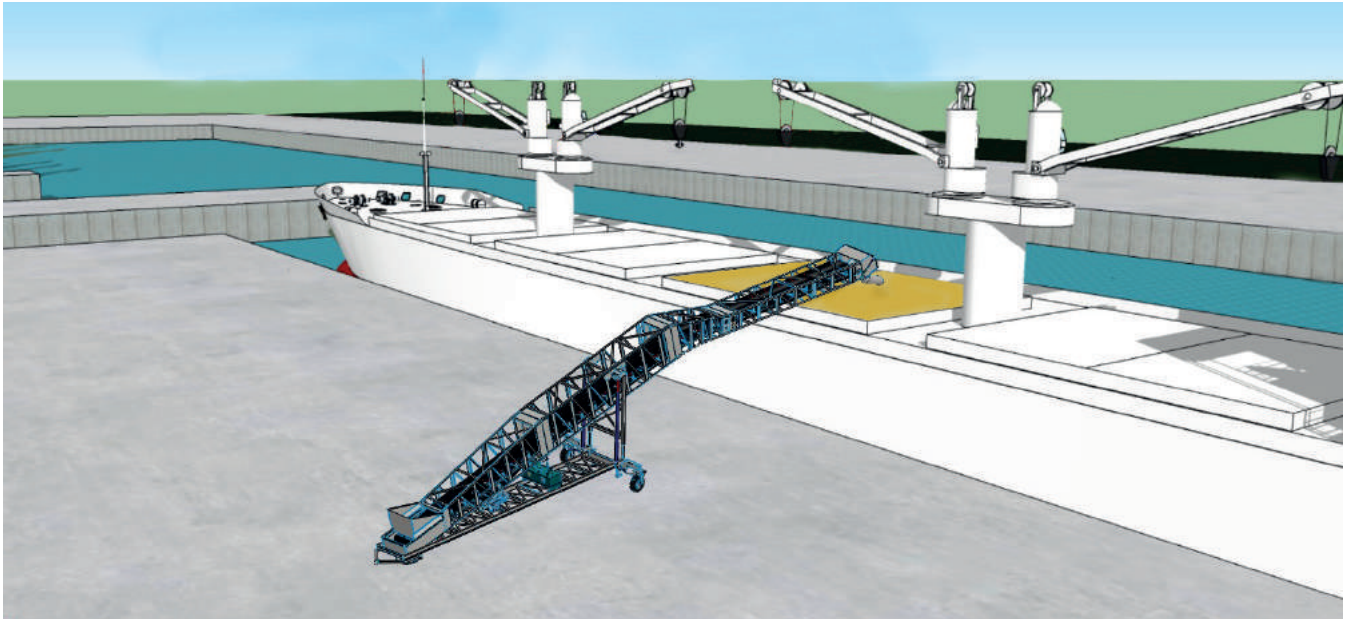

### Dimension Chart

MODEL	Angle	A	B	C	D
BC-M1235	22°	36750	9450	12300	35000
	13°	37520	3370	6500	35000

### Capacity Chart

MODEL	Belt Width	Unit	Belt Speed		
			2,1	2,6	3
BC-M1235	1200	t/h	500	600	700
		m³/h	657	790	920

- \* Dimensions are given as mm.
- \* Product density for capacity calculation is calculated as 769 kg/m³.
- \* The data on the chart are approximate values.
- \* Maxporter has the right to change the technical specifications.