

Our Maxporter U Model chain carriers are durable, long lasting and high quality. High capacity with low energy suitable for performance. Our conveyors are guests and comply with occupational health and safety rules.

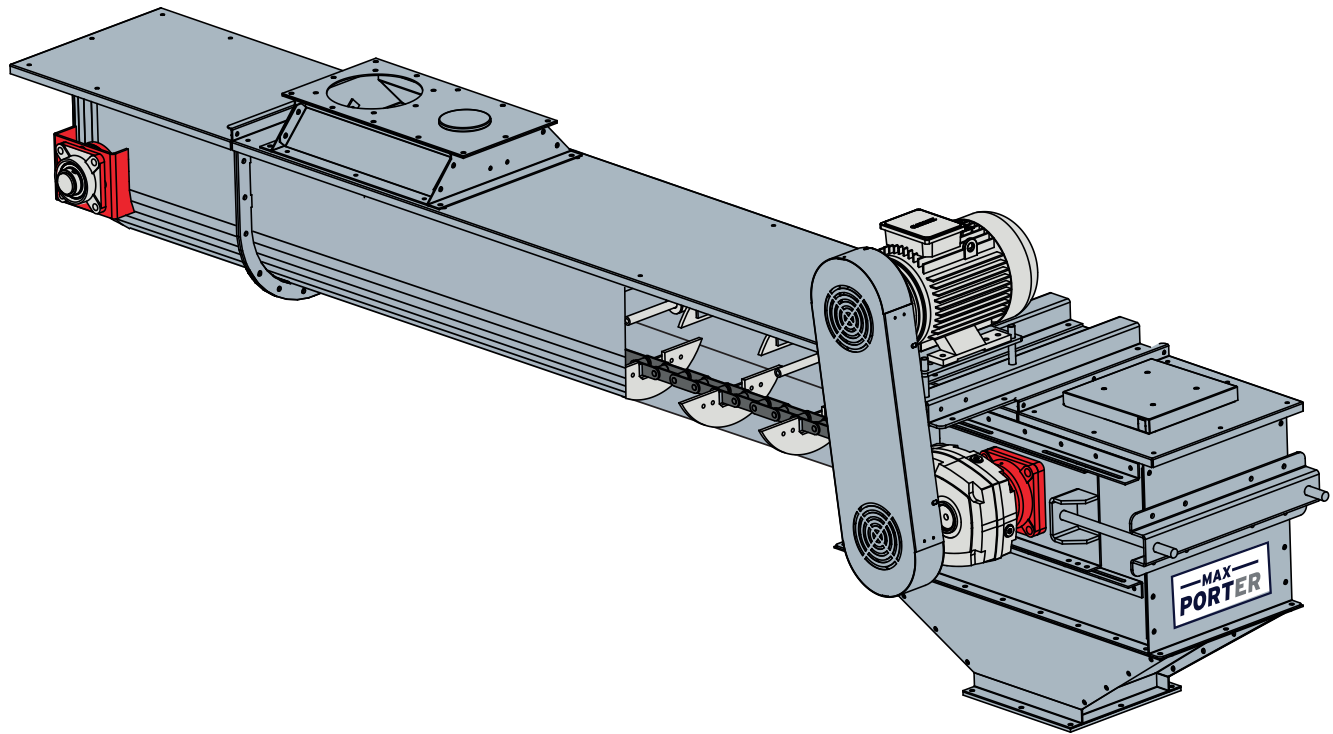

PRODUCT FEATURES

Our U Model chain transports are manufactured from galvanized sheet metal. In this way, it is long-lasting against failures.

Chains operating at different loads are used in our conveyors, depending on the capacity and model. Thanks to the anti-static pallet, return bucket and dust-proof wick, the risk of dust explosion is minimized. Due to its U-type case design, it has a self-cleaning feature that does not leave any findings in it after operation.

Since our conveyors are modular and standard structure, spare parts supply and technical service are easily provided.

STANDARD EQUIPMENTS:

- K Model Drive
- Belt Pulley Casing
- Discharge Chamber
- Inlet Chamber

OPTIONAL EQUIPMENTS:

- A Model Drive
- RPM Sensor

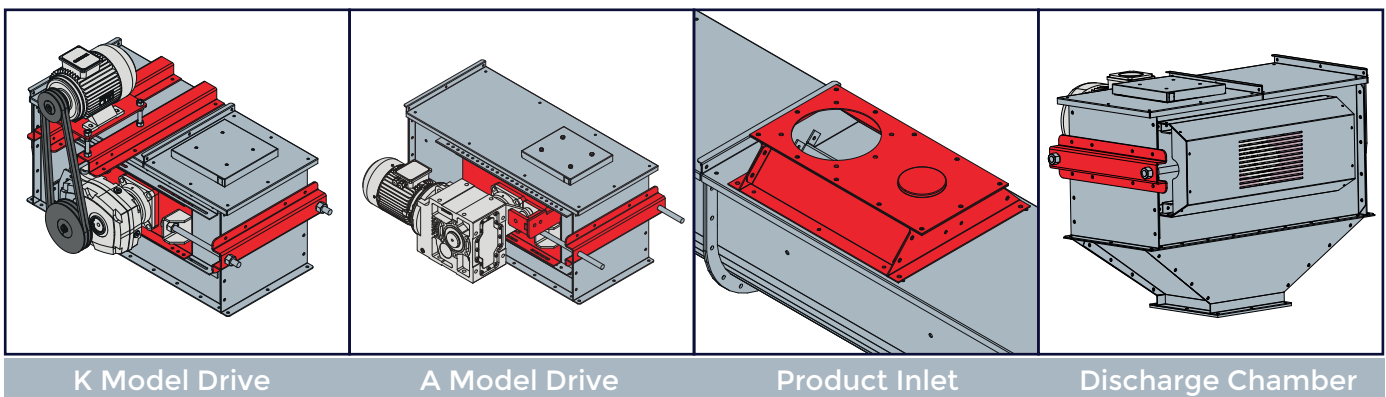

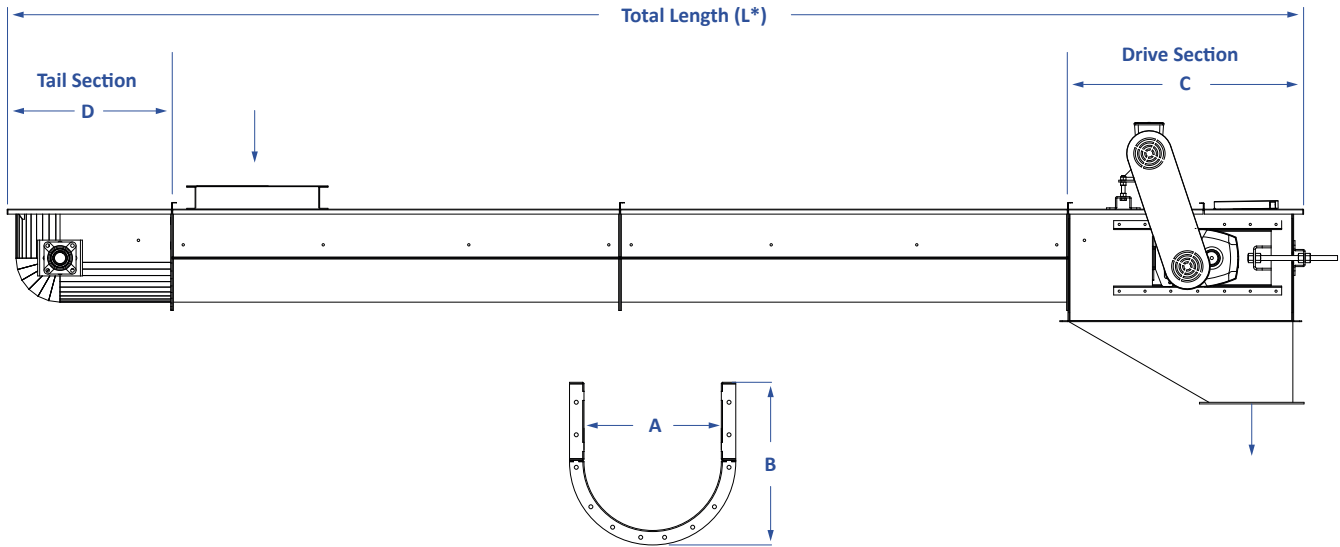

Capacity Chart					
	1821	2528	3841	4450	5161
A x B (mm)	180 x 210	250 x 280	380 x 410	440 x 500	510 x 610
Capacity (t/h)	25	50	100	150	200
Capacity (m ³ /h)	35	70	140	200	265
Chain Speed (m/s)	0,60	0,60	0,60	0,75	0,75
Chain Type	81X-81XH	81X-81XH	81X-81XH	81X-81XH	81X-81XH
Chain Link (mm)	66,27	66,27	66,27	66,27	66,27
Chain WLL (kN)	107 - 152	107 - 152	107 - 152	107 - 152	107 - 152
Intermediate Bodies Side and Base Sheet Thickness	2,5 / 2,5	2,5 / 2,5	3 / 3	3 / 3	3 / 3

- The data in the chart are approximate values.
- Product density has been calculated as 769 kg/m³ for ton calculation.
- Maxporter has the right to change technical specifications.

SPO.KTLG.45/00/21.12.2022-E