

Truck Loading Conveyor provides unloading of products at a predetermined angle and height on desired vehicles such as truck, lorry or trailers. The required energy is supplied by the tractor tail shaft without electricity.

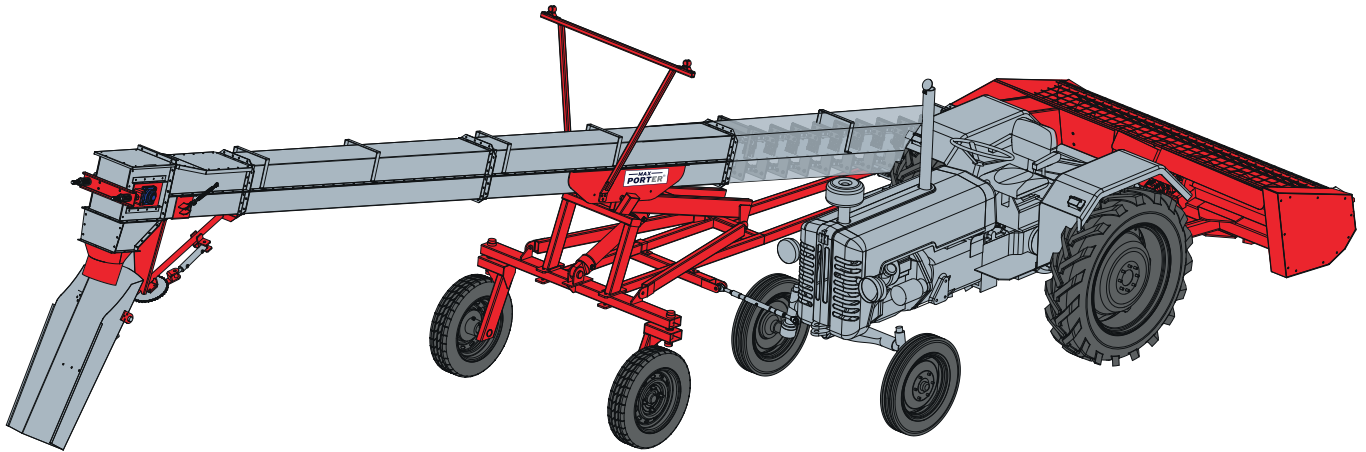

## PRODUCT FEATURES

Truck Loading Conveyor provides safe and fast conveying of products by the auger system and chain conveyor in its structure. The equipment can operate maximum 270 t/h (calculation is considered as 769 kg/m<sup>3</sup> product density). It is easy to move because of its tractor and high mobility capability. The help of the pistons on it allows the equipment to unload at determined heights and angles due to its tractor hydraulic without any the external hydraulic unit requirement.

### STANDARD EQUIPMENTS:

- Inlet Chamber with Flight
- Chain Body
- Discharge Chamber with Tail
- Chassis
- UCF, UCP Bearing
- Tractor Medium Strut
- Double Friction Lining Shaft

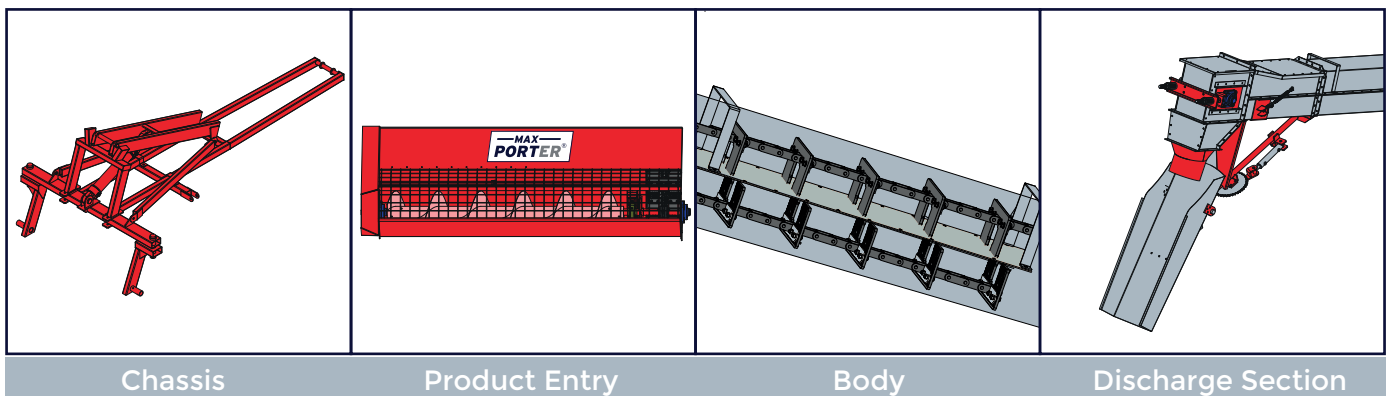

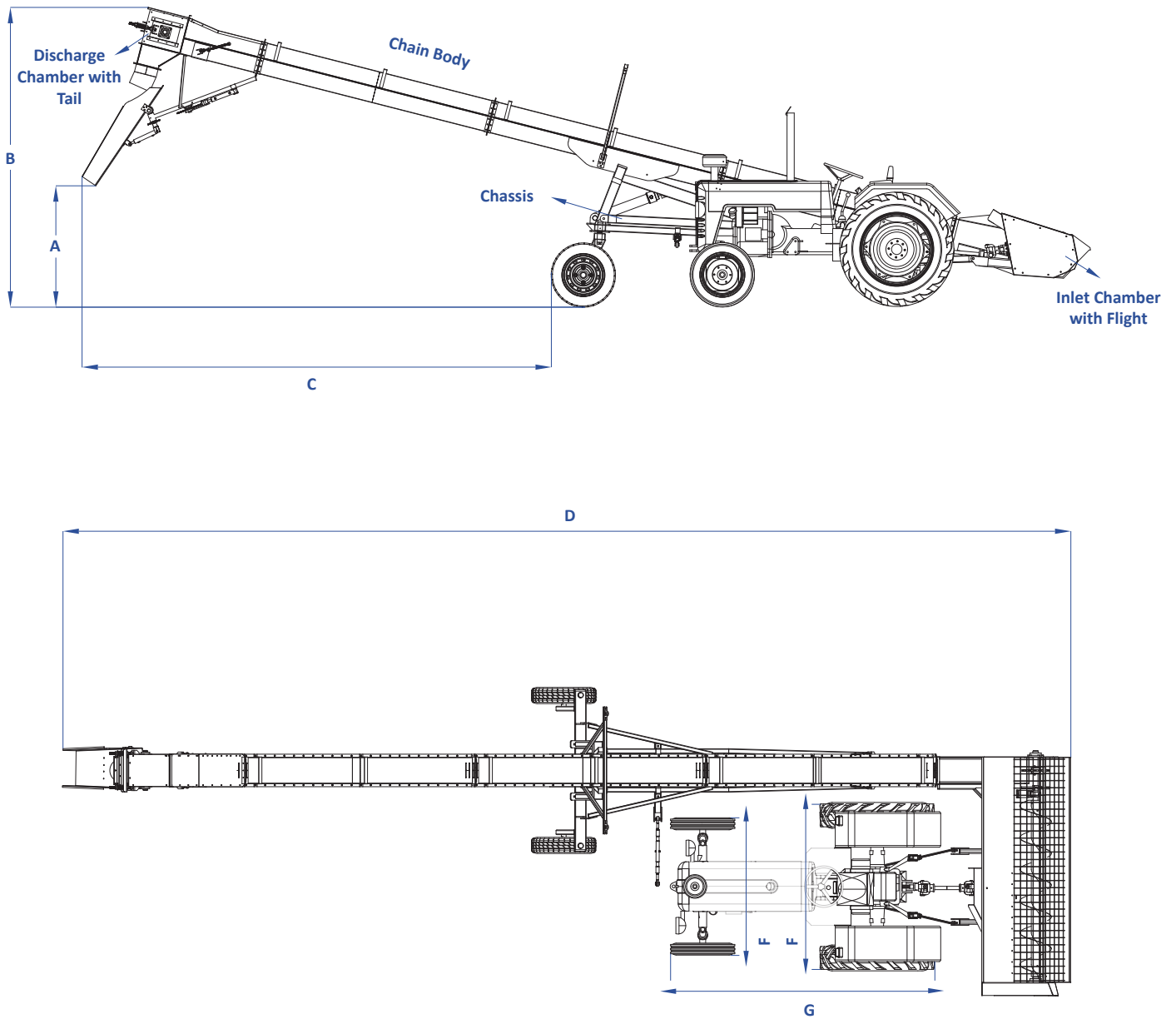

### Capacity Chart

Model	A (min)	A (max)	B (min)	B (max)	C	D	E	F (max)	G (max)
KYK-090	2.000	5.000	3.700	5.700	6.250	13.000	3.900	2.000	4.200

- Dimensions are given as mm.
- The capacity calculation is considered as 769 kg/m<sup>3</sup> product density.
- The values on the chart are approximate.
- Maxporter has the right to change the technical features.